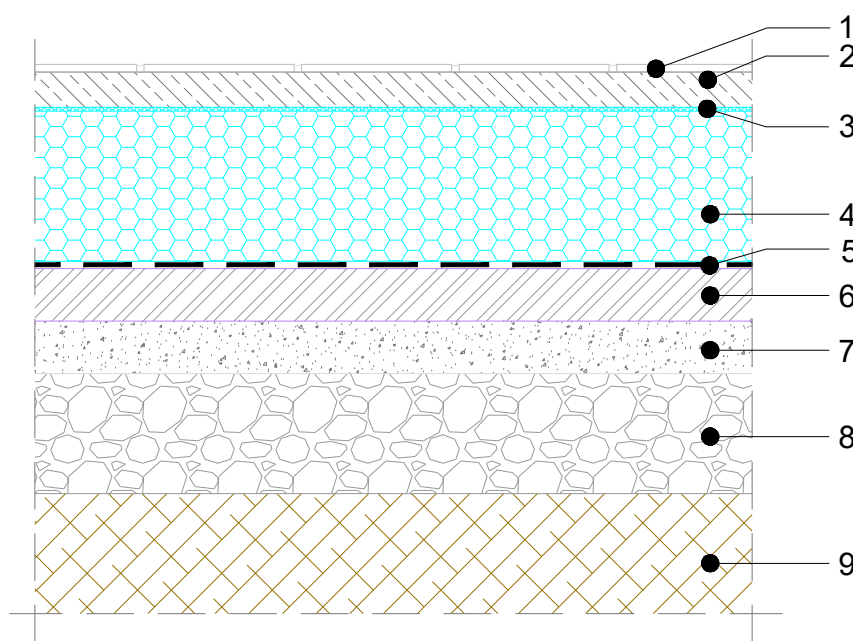

FLOOR AT THE GROUND LEVEL
FOUNDATION SLAB - LOW ENERGY BUILDING
WATERPROOFING LAYED ONTO LEAN CONCRETE
BASIC SECTION, M 1:10

4.02.1.0.00

COMPOSITION OF SYSTEM SOLUTION (dimensions in the detail to be calculated):

1. CERAMIC TIES
2. CEMENT SCREED
3. EXTRUDED PE FOIL – IMPACT SOUND INSULATION
4. FIBRAN *xps* 300-L
5. WATERPROOFING
6. LEAN CONCRETE
7. LEVELING SAND
8. CRUSHED GRAVEL
9. COMPACTED SOIL

NOTE: - It is not allowed to work with an open flame in the close proximity of the XPS insulation.
- When using PVC membranes, a separation layer (i.e. FIBRAN *filter* SF32) must be installed between the PVC membrane and the XPS.