

**FLOOR AT THE GROUND LEVEL**

**SEISMIC FOUNDATION PILLOW** whereas  $a_g \geq 0.1g$

WATERPROOFING ONTOP THE FOUNDATION SLAB

BASIC SECTION

M 1:10

**4.12.1.0.00**

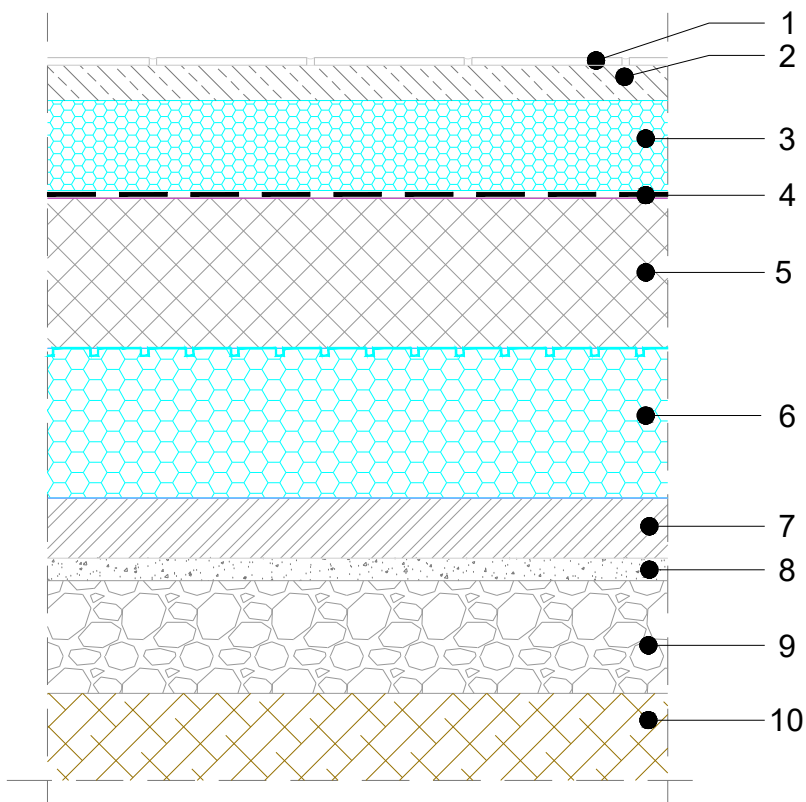

COMPOSITION OF SYSTEM SOLUTION (dimensions in the detail to be calculated):

1. CERAMIC TILES
2. CEMENT SCREED
3. FIBRAN *xps* – DUCKTWORK SPACE
4. WATERPROOFING
5. REINFORCED FOUNDATION SLAB
6. FIBRAN *xps* SEISMIC 400–L (500–L, 700–L)
7. LEAN CONCRETE
8. LEVELING SAND
9. CHRUSHED GRAVEL
10. COMPACTED SOIL

NOTE: - It is not allowed to work with an open flame in the close proximity of the XPS insulation.